

**MANUAL FOR INSTALLATION
& MAINTENANCE**

FOOD WASTE DISPOSER

MFD-1102

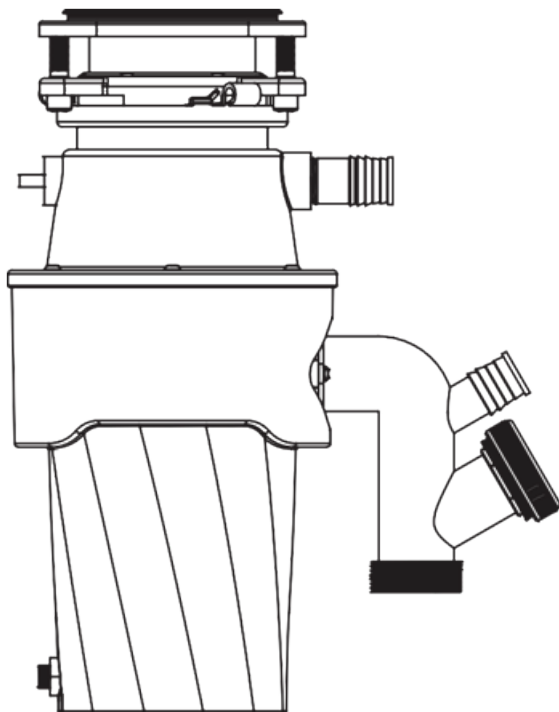

Dear user,

Thank you for purchasing our waste disposer! For better and safer use of this product, please read this instruction manual carefully before use and keep it for future reference.

The waste disposer helps you dispose food waste quickly and conveniently, reducing pests, bacteria and kitchen odors, improving the living environment and hygiene conditions greatly reducing labor intensity of cleaning food waste.

This product is easy to operate and easy to install. It can quickly crush food waste into tiny particles so that they can be washed away along the water flow. It will both improve your life quality and make a contribution to environment protection.



Warning

1. This product should be installed and used in accordance with local electrical specifications, and at least 10A wire and circuit switches should be installed.
2. To avoid electric shock, turn off the disposer power switch and unplug the power plug before installing or servicing.
3. If you are non-professional and the kitchen does not have suitable electrical circuits and sockets reserved, please contact a qualified electrician for handling.
4. Do not modify the device by yourself.
5. All wiring must comply with local power codes.
6. If the power cord is damaged, it must be replaced by a manufacturer/major manufacturer's service agent or similar qualified personnel to avoid danger.
7. Do not extend your hand into the feed port.



Note:

Before installing and using the device, please read the instructions in detail to fully master the technical features and use methods of the device. We recommend that the installation be carried out by qualified professionals and must always be installed in accordance with the relevant drainage piping and electrical regulations.

OPERATION INSTRUCTIONS

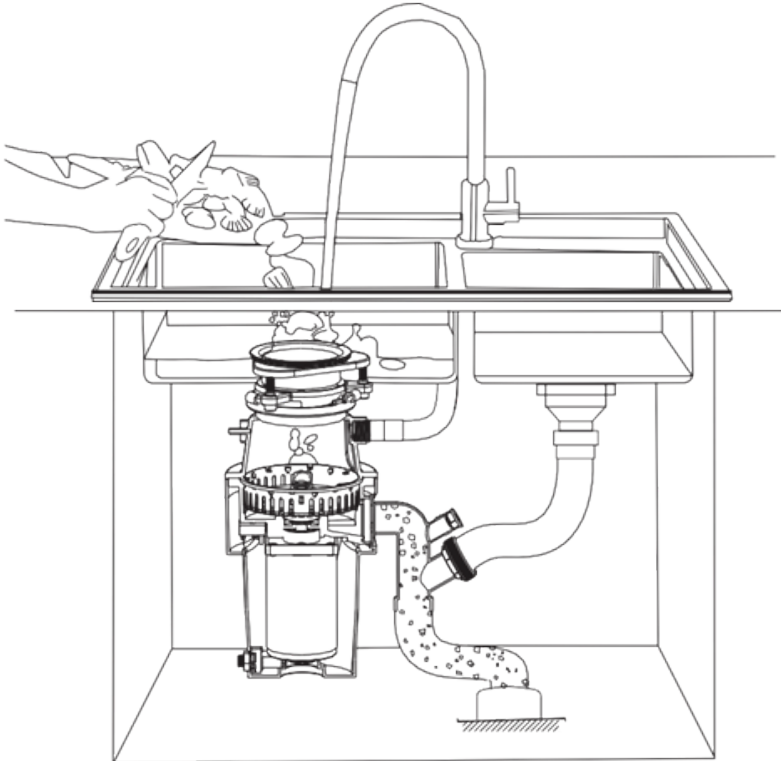

1. Steps:

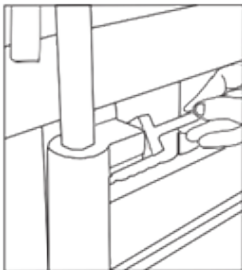

1 Turn on the tap to run a steady stream of cold water into the sink before turning on the waste disposer.

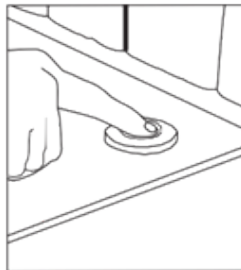

2 Press the air switch to activate the waste disposer.

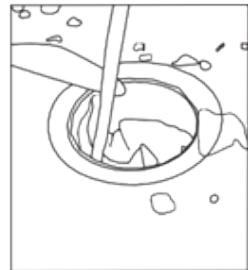

3 Gradually feed food waste into the disposer.

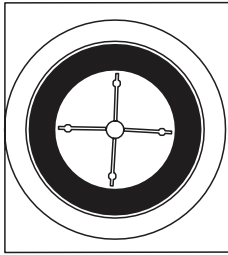

4 The disposer is done when you can hear the sound of water flowing



5 Press the air switch to turn off the waste disposer.

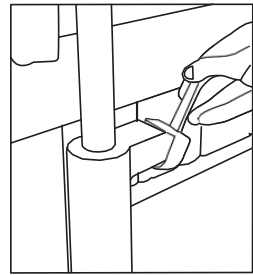

6 Let water run for a few seconds to flush the drain pipe. Then turn off the tap.

2. Product Model and Configuration

Model Code	FD1102
Type Of Motor	DC Permanent Magnet Motor
Motor Power	1/2HP (400w)
Volume Of Inner Bin	1.2 L
Flange Diameter	114 mm
Switch Configuration	Air Switch
Splash Guard and Acoustic Enclosure Configuration	Magnetic Splash Guard
Overload Protection	Yes
Dishwasher Interface	Yes

3. Parts List

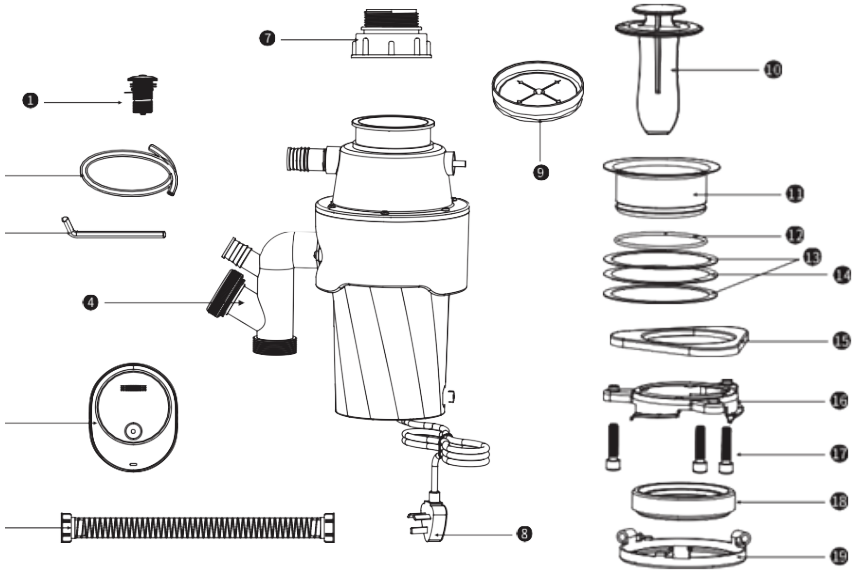

1. Air Switch	8. Power Cord	15. Triangle Plate
2. Pvc Connecting Pipe Of Air Switch (Optional)	9. Splash Guard	16. Upper Fastener
3. Hex Wrench	10. Pushing Rod (Assembly)	17. Screws (3 pcs)
4. Four-way Drain Pipe	11. Water Outlet	18. Flange Sealing Ring
5. Wireless Switch (Optional)	12. Circlip	19. Lower Fastener
6. Connecting Hose	13. Silicone Sealing Ring (2 Pieces)	Description: The Specific Configuration Shall Be Subject To The Actual Model.
7. 50 To 40 Connector	14. Fiber Washer (Black)	

4. Installation Instructions

Check installation dimension (see Figure 1).

1. The height from the bottom of the kitchen cabinet to the bottom of the sink must exceed the total height of the product within 37cm.
2. The width of the kitchen cabinet must be longer than 29cm.

Note: To prevent accumulation of water in the disposer, the drain pipe inserted into the wall/ floor drain must be lower than the disposer drain.

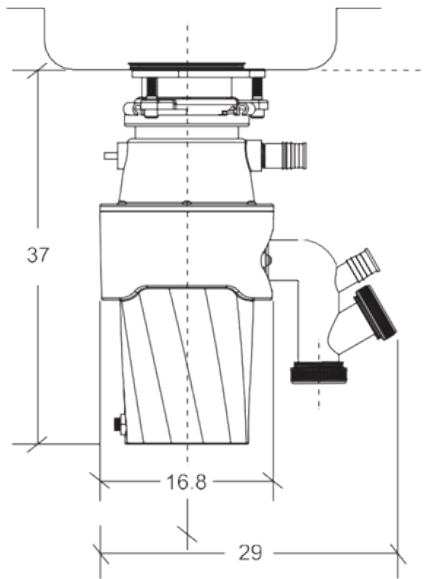

Figure 1 Unit: CM

A. Installation Tool.

Prepare the following tools before installing the equipment:

Cross Screwdriver	Steel Saw	PVC Glue (for rigid pipe connection)
Straight Screwdriver	Hammer	33mm Diameter Drill Bit (Quartzite/Stainless Steel)
Electric Drill	Scissors	4mm Diameter Drill Bit
Adjustable Spanner	Raw Material Belt	
Blowdown Auger	Pipeline Tongs	

B. Disconnect the sink from the drain pipe (see Figure 2).

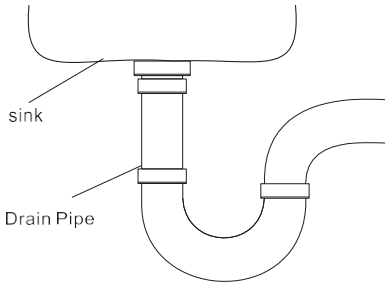

Figure 2

C. Disassemble The Circlip On The Water Outlet And Flange Assembly.

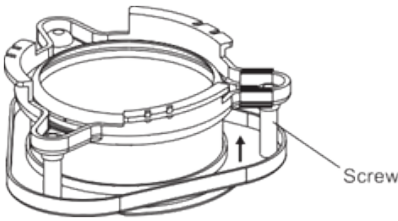

Figure 3

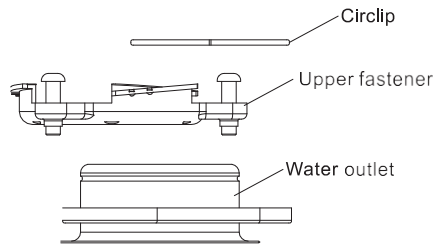

Figure 4

Take out the water outlet and flange mounting assembly from the fitting box and loosen the three retaining screws with a hex wrench until the circlip is exposed (see Figure 3).

Use a screwdriver or use any tool to lift the circlip out of the water outlet so that the circlip falls off, and then separate the outlet from the flange assembly (see Figure 4).

Special Tips: The standard flange diameter of this product is 114mm. If you have a different size in your sink, you need to select the reducing diameter component of the water sink for normal installation. You need to use an adapter/reducer.

D. Connect the outlet and flange assembly to the sink (See Figure 5).

1. Make sure that there is no debris in the drain outlet, place a red silicone gasket between the drainer and the outlet. Keep it stationary (b) through the water outlet (a) and fill it into the water sink hole, you may need to place a heavy object in the sink or hold it down with your hand to keep the outlet stationary.
2. Under the sink, the black fiber washer (c), the red silicone gasket (d), the triangle plate (e), and the upper fastener (f) drainer instead of water outlet in the entire document Snap circlip (h) into the groove at the bottom of the water outlet.
3. Tighten the three retaining screws (g) until the outlet and flange assembly are mounted smoothly on the water sink.

Special Attention: Improper operation will cause water leakage, make sure to check whether all retaining screws are tightened by hex wrench. Normally it is considered to be installed in place if the whole flange assembly will not rotate when it is screwed with a hex wrench.

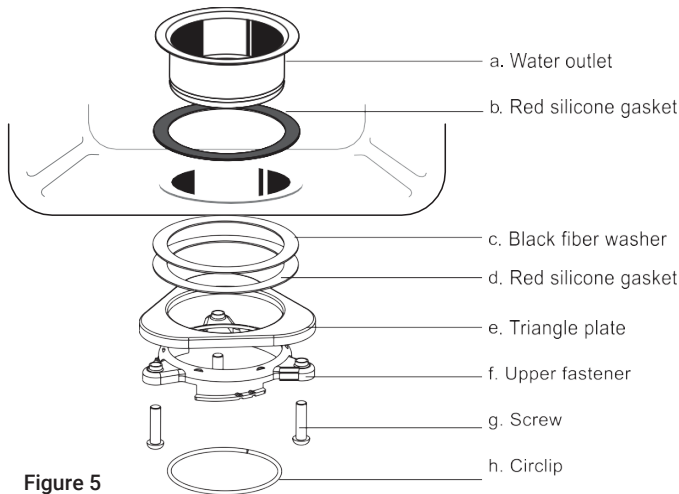

Figure 5

E. Clean the drain pipe of the sink. If you use brand-new pipe fittings, please ignore this step.

1. Use pipeline tongs to remove the U-shaped pipe (see Figure 6).
2. Use a blowdown auger to remove hardened waste from drains.

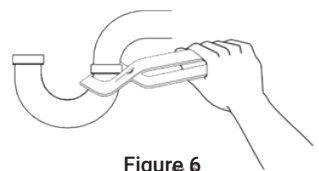

Figure 6

F. Connecting drain pipe.

1. Align the four-way drain pipe assembly with the machine drain port and push it in (see Figure 7 before installation, the four-way assembly must be checked for waterproof rings).
2. Put two M5 screws into the screw holes and tighten with a cross screwdriver.

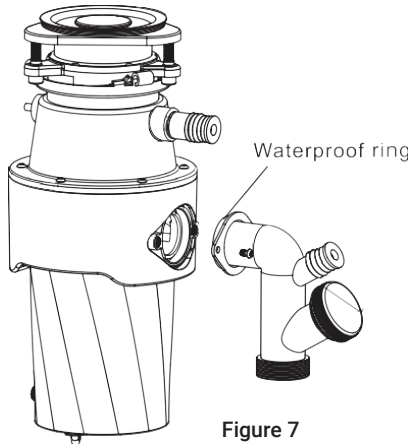

Figure 7

G. Hang the disposer onto the sink.

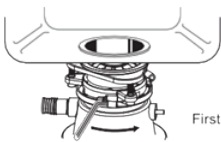

Figure 8

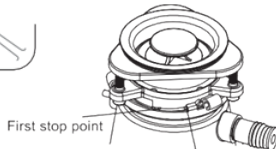

Figure 9



Figure 10

1. Remove all items inside the disposer before installing the disposer onto the sink.
2. When installing this product, make sure that the motor reset button at the located bottom of the disposer is easily accessible and that there are no other items in this space.
3. Adjust the position of the disposer to ensure that the three hooking points of the lower fastener are hung with the upper fastener of the flange (see Figure 8).
4. Insert the flange mounting hole with a hex wrench and rotate to the right until the mounting hook is secured to the upper fastener it should pass the second stop point (see Figure 9).
5. Insert the splash guard into the sink outlet (see Figure 10).

Note: Do not place your head or other parts of your body under the disposer to avoid human hazards caused by falling equipment due to improper installation during installation.

H. Connection of drain pipe of dishwasher and sink overflow pipe.

1. For the sink with overflow hole, pull out the soft plug on the overflow pipe interface (12 a), and then plug the overflow connection pipe (see Figure 11).
2. Connect the dishwasher drain pipe to the disposer dishwasher inlet (see Figure 12 b) Dishwasher interface).
3. Connect the four-way drain pipe to the upper and lower water pipes and insert it into the floor drain. Drain water into the sink and check for leakage.

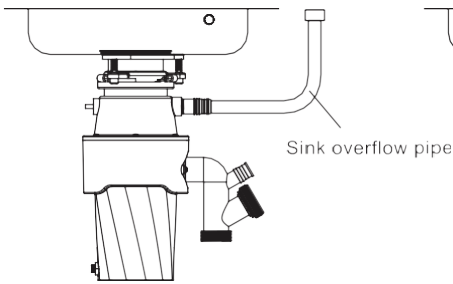

Figure 11

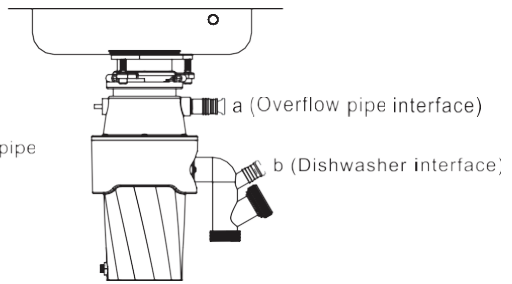
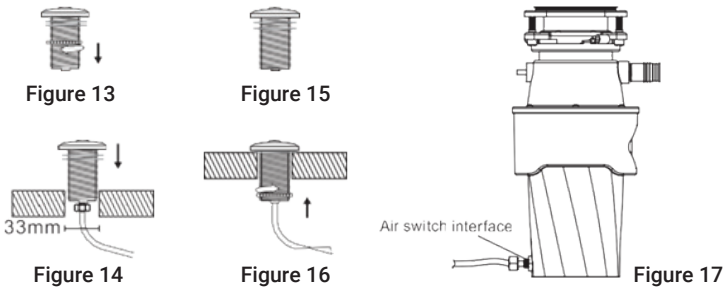

Figure 12

Note:

1. Please remove the soft plug before installing the overflow pipe as shown in Figure 12a.
2. Please remove the soft plug to connect the dishwasher as shown in Figure 12b.

I. Installation/power connection of air switch and wireless switch.



1 Installation of air switch

1. Check whether there are proper or reserved holes on the sink and table to install the air switch button; otherwise, the installation hole with a diameter of 33mm shall be set at the proper position of the table or sink.
2. Remove the metal gasket and nut of the air switch (see Figure 13), insert one end of PVC connecting pipe into the nozzle of the air switch, screw on the fastening nut (see Figure 15), and pass the other end through the hole on the operating console.
3. Install the air switch into the hole and install the gasket and nut removed in Step 2 (see Figure 16).
4. Take up the other end of the PVC connecting pipe and insert it into the air switch interface of the disposer and screw on the fastening nut (see Figure 17).

2 Wireless switch installation: (Optional)

1. Install two AAA batteries according to the positive and negative battery marks (see Figure 18).
2. Install the battery door onto the wireless switch and remove the back glue isolation paper (see Figure 20).
3. In order to avoid misoperation by children, it is recommended to paste the wireless switch at a position more than 1.2m from the ground. Before pasting, wipe the wall with a cloth and then stick it to the wall surface according to the direction indicated by the arrow (see Figure 23).

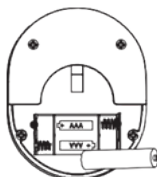

Figure 18

Note: The shape of the wireless switch shown above is for reference only. Different product models may be matched with wireless switch of different appearances.

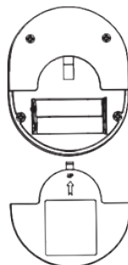

Figure 19

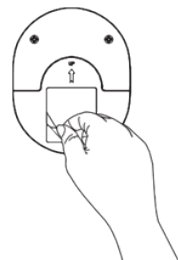

Figure 20

4. When replacing a new wireless switch, it is required to reconnect with the disposer code matching in the following manner:

Ensure that the disposer is powered on, first press and hold the receiving box switch and hold it still, and then press the wireless switch shortly. If the code is successfully matched, the disposer will start. If the disposer does not start, please try again.

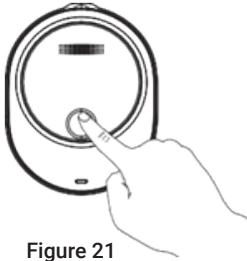

Figure 21

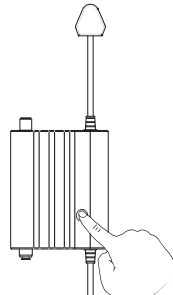

Figure 22

3 Operation method of wireless switch:

- a. Press the operation switch ON/OFF shortly, and the LED will flash once every time (see Figure 21).
- b. Child lock status: Press the key for 3 seconds and the LED flashes for 3 times to enter the child lock state. When pressing the key again, the machine cannot be started. The LED flashes red quickly.
- c. Unlocking status of child lock: Press the key for 3 seconds, the LED flashes green for 3 times, the child lock releases and the wireless switch can be used normally.

4 Power cord installation

- 1 Before purchasing this product, first confirm whether there are reserved sockets in the proper position in the cabinet. Note that it must be a three-hole socket with earthing.
- 2 Find the proper power socket and connect the power cord (see Figure 23).

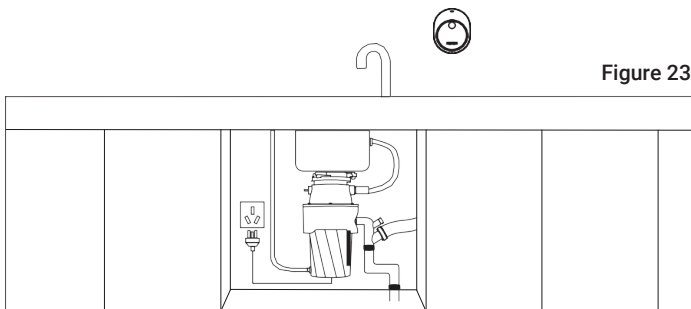

Figure 23



Note:

1. Before use, please read the instructions and do not allow children to operate the waste disposer.
2. Users are not allowed to disassemble, modify or repair the garbage disposer by themselves
3. When using, turn on the tap before turning on the disposer. After the food residue has been crushed, it should be continuously rinsed with water so that the residue and the detergent with corrosion properties do not remain in the disposer and do not use the disposer when the drain pipe is blocked.
4. Do not run under continuous load for more than 5 minutes, and each interval should be more than 30 minutes.
5. The garbage disposer is designed for the disposer of food garbage in the kitchen, and plugging in objects other than food garbage may cause damage to the machine and loss of personal property.
6. Do not pour boiling water into the machine when it is running to avoid splashing and injury to human body.
7. To reduce the risk of injury, do not use the sink for any improper use other than food washing (e.g. shampooing and bathing young children).
8. Turn off the machine only after the food residue is crushed and the machine and water flow are heard.
9. Before attempting to handle stuck rotating parts with tools, turn off the machine power switch and unplug the power supply plug.
10. When garbage disposer is not used, cover the sink, cover the drainer prevent foreign matter from falling in.
11. It is prohibited to dispose of special hard materials or objects such as glass and metal.

Imp.- The waste can be disposed of:- residual rice, livestock bones, fish bones, vegetables, peel, fruit shells, tea residues, corn cob core and other food wastes.

Non-disposable garbage:- glass, ceramic, metal, plastic, leather, rubber and other wastes.

Disposal of garbage is not recommended:- Fish scales, large bones, pig skulls, bovine bones, corn coats, hair (because of longer processing times and louder noises during treatment).

5 Daily maintenance

For long-term use, grease/dirt builds up on the grinding chamber and splash guard, creating an unpleasant smell and therefore requires regular cleaning of the disposer (It is recommended to clean once every 15 days):

1. Turn off and cut off the power supply.
2. Clean the dirt inside and outside the opening of the garbage disposer and inside the splash guard with cleaning solution.
3. Cover the plug of the water sink, inject slightly warm water about half the sink, and then add soda powder.
4. Turn on the power supply and start the disposer, pull out the plug and flush the residual particles inside.

6 Disclaimer

In case of any one or more of the following circumstances, it shall not be included in the scope of free maintenance.

- 1 Remove the cover and shell of the machine without authorization of our company.

- 2 Parts damaged or missing due to human factors.
- 3 The crushed objects are beyond the designated food waste category, such as iron nails, stones, metal objects, etc..
- 4 Pulverize a large amount of food waste with high fiber content (such as a large amount of hair or corn coat), causing fiber winding machine, blockage or damage.
- 5 There is no warranty card or bill, the product is inconsistent with the bill, or the bill is altered.
- 6 Damage caused by force majeure, such as earthquakes, floods, typhoons, hail-storms and other natural disasters.
- 7 Consumables (including splash guard, air switch connection hose, four-way pipe, down-comer, water pipe joint, remote control, receiving box) are not covered by free warranty.

Troubleshooting:

During the daily use of the garbage disposer, the following problems may occur, which can be quickly eliminated according to the corresponding method, so that you can enjoy the cleaning and convenience that the garbage disposer brings to you better:-

Problem 1 : The machine rattles abnormally.

Cause of failure: Usually due to accidental fall-in of hard items (e.g. spoons or bottle caps) in the shredding bin.

Solution: Turn off the disposer and water flow switch firstly, disconnect the power supply. After the disposer stops rotating, check the shredding bin and remove foreign matters with a long clamp.

Problem 2 : Slow discharge of waste.

Cause of failure: Due to partial blockage of drain pipe. Solution: Remove with elastic rod specially used by plumber.

Problem 3 : Water leaks above the disposer.

Cause of failure:

- 1 The water sink and the disposer flange interface are not effectively connected; the upper fastening screw is not tightened; the rubber sealing ring is not installed effectively.
- 2 If water leaks from the disposer outlet, the connection screw may be loose or the water pipe is broken.

1 Solution:

- 1 Check whether the rubber sealing ring is effectively installed, tighten the three fastening screws on the upper fastening fastener simultaneously, or replace the sealing rubber ring.
- 2 Check whether the drainage outlet is abnormal, tighten the connecting screw or replace the drainage pipe.

Problem 4 : The motor stops rotating while the disposer is operating.

Cause of failure: It is stuck due to foreign matter falling in. Solution:

- 1 Unplug the power plug of the disposer.
- 2 Check the shredding bin and take out the foreign matters with long clips or chopsticks.
- 3 Insert the allen wrench in the fitting into the hexagon maintenance hole in the middle of the bottom of the machine and rotate clockwise/counterclockwise (see Figure 24) until the rotation is smooth.
- 4 Press the red reset switch button on the side of the machine (see Figure 25). If the bottom is overheated, do not reset forcibly. After 30 minutes of product cooling, do the reset operation.

5 Plug in the power supply and start the disposer.

Problem 5 : Start the disposer and the motor does not rotate.

Cause of failure: The plug connection may be poor, the power line is damaged, the air pipe is loose, the reset button is not pressed in place, etc.

Solution:

- 1 Pull out the power plug, check whether the plug and power cord are in good condition, and replace if there is any damage.
- 2 Check whether the air pipe is loose and leaked (see Figure 17).
- 3 Check whether the machine body is in high heat state, and perform the reset operation after 10
- 4 If the motor remains stationary, please contact morzze Customer Service Center.

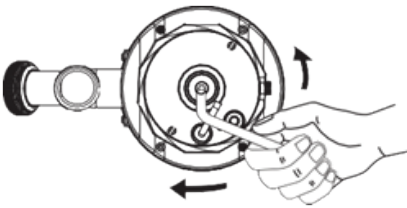

Figure 24

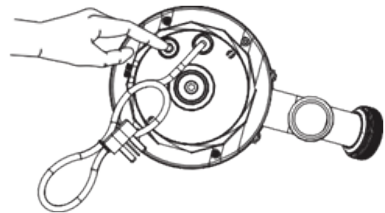

Figure 25

MORZZE

Beyond Excellence...



FIND US!